

# IPC-603MB

## Ultra Compact 2U Rackmount Chassis with Front-accessible I/O Cabling

**NEW**



### Features

- The best embedded computing system for machinery applications
- Ultra compact 2U-high chassis supporting ATX/mATX motherboard
- Streamlined in-chassis airflow design supporting LGA775 Pentium® 4 CPU up to 3.8 GHz with suggested CPU cooler
- All I/O interfaces are in the front
- Shock resistant disk drive bay design to hold one slim CD-ROM and one internal 3.5" HDD
- Specially designed riser card supporting up to three half-sized PCI cards
- Equipped with 1U-high 300W ATX PFC power supply
- Easy-to-replace air filters



### Specifications

		Front-accessible	Internal
Drive Bay	Slim CD-ROM	1	-
	3.5"	-	1
Cooling	Fan	2 (47 CFM each)	
	Air Filters	3 (85 x 80 mm)	
Miscellaneous	Notification LEDs	PWR & HDD (internal)	
	Riser card (9696070000)*	Supports up to three half-sized PCI add-in cards	
Environment		Operating	Non-Operating
	Temperature	0 ~ 40 °C (32 ~ 104 °F)	-20 ~ 60 °C (-4 ~ 140 °F)
	Humidity	10 ~ 85% @ 40° C, non-condensing	10 ~ 95% @ 40° C, non-condensing
	Vibration (5 ~ 500 Hz)	1 Grms	2 G
	Shock	10 G (with 11 ms duration, half sine wave)	30 G
	Acoustic Noise	Less than 52 dB sound pressure at 5 ~ 28 °C (41 ~ 82 °F)	
	Altitude	0 to 3,048 m (0 ~ 10,000 ft)	
Physical Characteristics	Dimensions (W x H x D)	482 x 88 x 310 mm (19" x 3.46" x 12.2")	
	Weight	8 kg (17.6 lb)	

\* The riser card is specially designed to support Advantech AIMB-500 and AIMB-700 series motherboards. There might be compatibility issues with other vendor's motherboards.

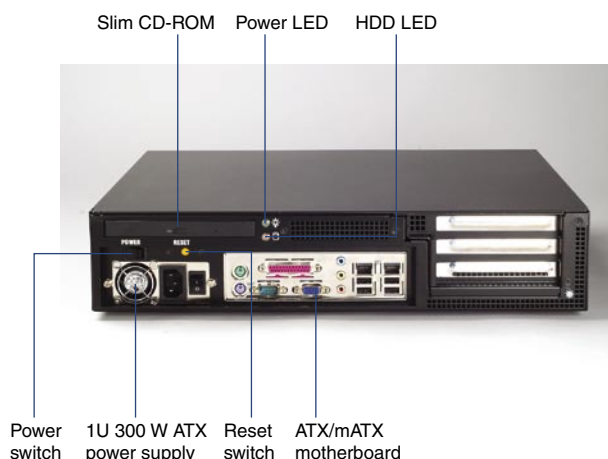

The front view of IPC-603MB

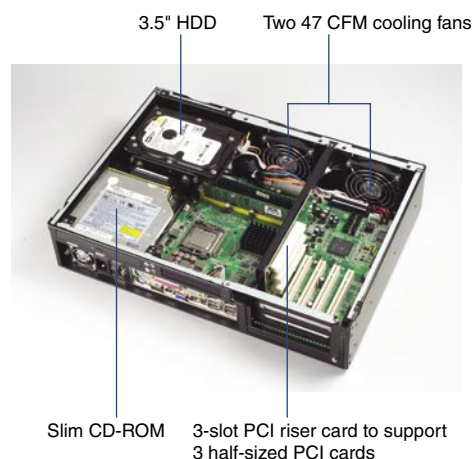

The inside view of IPC-603MB

## Dimensions

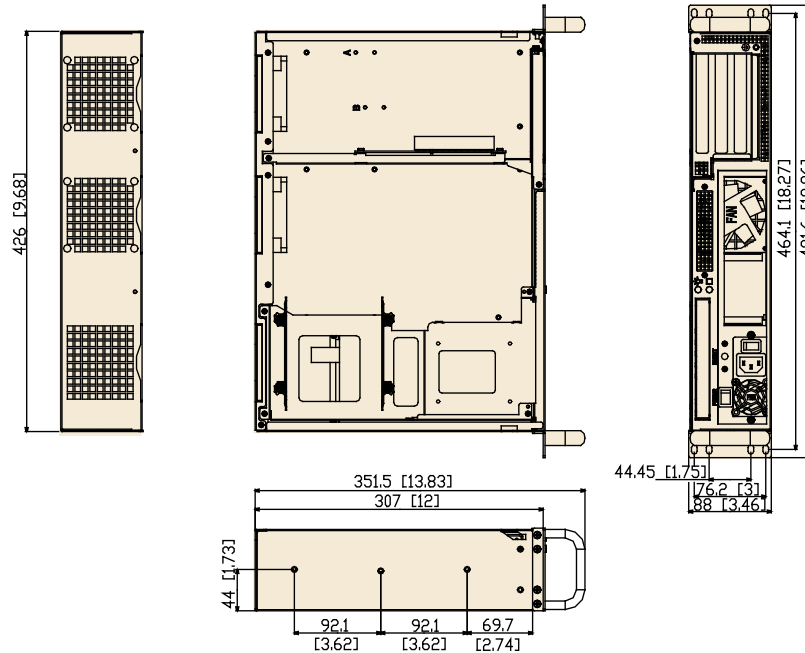

Unit: mm (inch)

## Power supply

Part Number				Specifications		
	Watt	Input	Output	Mini-load	Safety	MTBF
1757000160G (ATX, PFC)	300 W	AC 100 ~ 240 V (full-range)	+5 V @ 25 A, +3.3 V @ 14 A +12 V @ 16 A, -12 V @ 1 A -5 V @ 0.5 A, +5 Vsb @ 2 A	+5 V @ 3 A, +12 V @ 2 A -5 V @ 0.05 A, -12 V @ 0.05 A +3.3 V @ 1A, +5 Vsb @ 0.1 A	UL/TUV/CB/CCC	100,000 hours @ 25 °C

## Accessories

Part Number	Description
96SDVR-8X-I-QS-B	Black slim-type DVD RW-ROM 24X/8X/24X
96SCD-24X-I-OD-B	Black slim-type CD-ROM 24X
1750000257	2U-high Socket 478 P4 CPU cooler up to 3.2 GHz (89 W)
1750000332	2U-high LGA775 P4 CPU cooler up to 3.8 GHz
1759200650	Fan 80 x 80 x 25 mm
1990001176	Fan filter 80 x 85 x 5 mm

## Ordering Information

Part Number	Power Supply	Riser Card	Motherboard	Regulation
IPC-603MB-30ZE	1757000160G	969K700R00E (for AIMB series only)	Not included (for AIMB series only)	CE