

# IPC-5120

## Compact Desktop/Wallmount Chassis with Front I/O Interfaces & Expansion Slots for Micro ATX Motherboard

**NEW**



### Features

- Compact desktop/wall mountable chassis for microATX motherboard
- Streamlined in-chassis airflow design supporting LGA775 Pentium® 4 CPU with suggested CPU cooler
- All I/O interfaces are in the front
- Shock-resistant disk drive bay design to hold one 5.25" drive disk and two 3.5" drive disks (one external & one internal)
- Supports up to four half-sized add-in cards in the front
- LED indicators for power status and HDD activity
- Equipped with 1U-high 300 W ATX/PFC power supply
- Easy-to-replace air filter

### Specifications

		Front-accessible	Internal
Disk Drive Bay	5.35"	1	
	3.5"	1	1
Cooling	Fan	1 (85 CFM) + 1 (10 CFM)	
	Air Filter	1 (133 mm x 112 mm)	
Miscellaneous	Control	Power on/off switch and system reset button	
	LED Indicators	Power status and HDD activity	
Environment		Operating	Non-operating
	Temperature	0 ~ 40 °C (32 ~ 104 °F)	-20 ~ 60 °C (-4 ~ 140 °F)
	Humidity	10 ~ 85 % @ 40 °C, non-condensing	10 ~ 95 % @ 40 °C, non-condensing
	Vibration (5-500 Hz)	1 Grams	2 G
	Shock	10 G (with 11 ms duration, half sine wave)	30 G
	Acoustic Noise	Less than 52 dB sound pressure at 5 ~ 28 °C (41 ~ 82 °F)	
	Altitude	0 to 3,048 m (0 ~ 10,000 ft)	
Physical Characteristics	Dimensions (W x H x D)	320 x 164 x 307 mm (12.6" x 6.5" x 12.1")	
	Weight	8.0 kg (17.6 lb)	

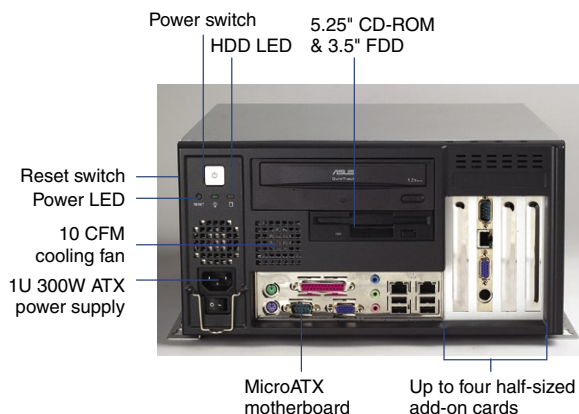

Solid disk drive housing & easy-to-maintain fan filter



Shock-resistant drive bay designed to hold an internal 3.5" HDD



Plug ring-lock securely fastens the power cord

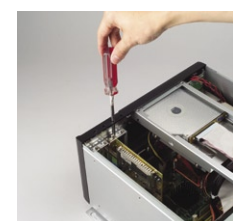

User-friendly mechanical design for installing an add-on card

## Dimensions

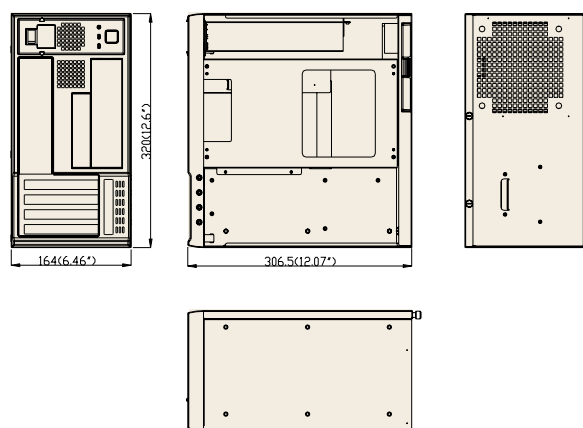

Unit: mm (inch)

## Installation

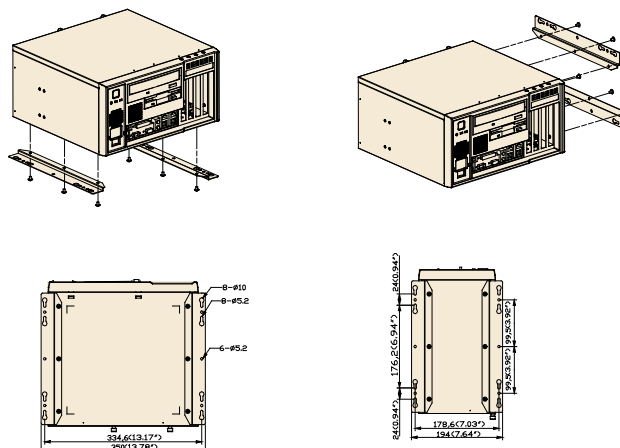

Unit: mm (inch)

## Power Supply Options

Part number	Specifications				
	Watt	Input	Output	Mini-load	Safety
1757000229G (ATX, PFC)	300 W	AC 100 ~ 240 V (full range)	+5 V @ 25 A, +3.3 V @ 14 A, +12 V @ 16 A, -5 V @ 0.5 A, -12 V @ 1.0 A, +5 Vsb @ 1.5 A	+5 V @ 3 A, +3.3 V @ 1.0 A, +12 V @ 2 A, -5 V @ 0.05 A, -12 V @ 0.05 A, +5 Vsb @ 0.1 A	UL/TUV/CB/CCC
					MTBF
					100,000 hrs @ 25 °C

## Accessories

Part Number	Description
96CD-52X-I-AS-B2	Black 5.25" 52X CD-ROM
96DVR-40X-I-AS-B	Black 5.25" 16X/40X/24X DVDRW-ROM
96FDD-144-TE-B1	Black 3.5" FDD
1750000257	2U-high Socket 478 P4 CPU cooler up to 3.2 GHz (89W)
1750000332	2U-high LGA775 P4 CPU cooler up to 3.8 Ghz

## Ordering Information

Part Number	Power Supply	Motherboard	Regulation
IPC-5120-30ZE	1757000229G	Not included	CE